



Description

The fixed temperature heat detector, Model CD series, is designed to sense a fixed temperature of air. It activates whenever the ambient temperature reaches the top temperature of detector setting (various settings are available.) It is incorporated a self-resetting bi-metallic disk element with response indicator.

Features

- Fixed temperature heat detector 70°C
- Mechanical operating heat sensor - for reliability
- Response indicator lights up to show which detector has activated
- Ease of installation and wiring connection - reduces installation costs
- Connections are non-polarized - reduces wiring mistakes
- Wide working voltage available to suit most control panels
- Self-resetting and requires no replacement of internal elements - reduces maintenance costs
- Power consumption 0A (idle mode)
- Compatible with Nittan B2-C, EVA-UB4, 3T base

Dimensions

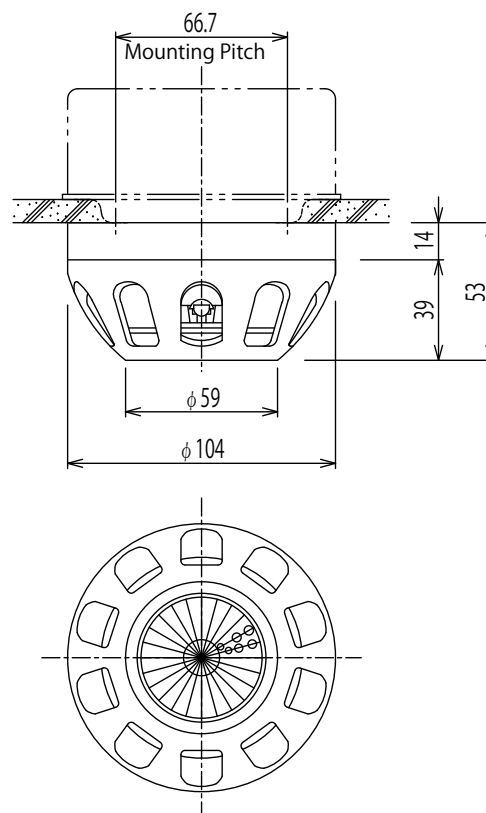

■ Wiring

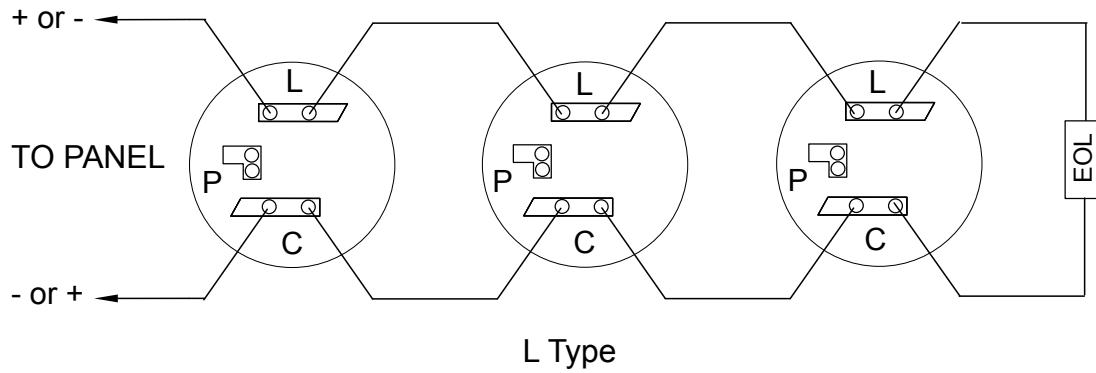

Typical 2-Wire Initiating circuit configuration

Wiring differs depending on Panel's specifications. Refer to the installation manual of the panels connected.

■ Specifications

| Specifications | 1CD-70-L |
|----------------------------------|---|
| Sensitivity | Class 1 (Standard) |
| Fixed Alarm Temperature | 70°C |
| Detector Element | Self-resetting bi-metalic disk element |
| LED Indicator | Red LED illuminates in an alarm condition |
| Rated Voltage | 24 VDC |
| Quiescent Current | 0 mA |
| Rated Contact Capacity | 30VDC, 50mA |
| Ambient Installation Temperature | -10°C to +50°C |
| Base | B2-C, 3T |
| Dimensions | ϕ 104 mm x H 39 mm (Detector head only) ϕ 104 mm x H 53 mm (with base) |
| Weight | Head : 85g Base : 45g |
| Label | Japanese |

Distributed By

All specifications are subject to change without any notice.
For more information, contact with NITTAN.

NITTAN

54-5, 1-chome, Sasazuka,
Shibuya-ku, Tokyo151-8535, Japan
TEL:81-3-5333-7021 FAX:81-3-5333-8615